

◀◀◀ e.g. – other types GT/HAS, see Page 8-9

Number of poles	Typ	U _n [kV]	U _p [kV]	U _d [kV]	I _n [kA]	I _{th} [kA]	I _{dyn} [kA]	Weight [kg]	PA	a	b	c	d
1,5 kV 3-pole	GT0.63-1.50-03-100-L1	1,5	12	4	630	20	50	15	100	--	362	332	--
	GT1.25-1.50-03-100-M1	1,5	12	4	1250	31,5	80	20	100	--	362	332	--
	GT1.60-1.50-03-100-M1	1,5	12	4	1600	31,5	80	22	100	--	362	332	--
	GT2.50-1.50-03-130-M1	1,5	12	4	2500	31,5	80	45	130	--	458	420	--
	GT3.15-1.50-03-150-M1	1,5	12	4	3150	31,5	80	52	150	--	498	460	--
	HA3.15-1.50-03-180-K1	1,5	12	4	3150	31,5	80	54	180	--	574	534	--
3,6 kV 3-pole	GT0.63-3.60-03-150-L1	3,6	40	10	630	20	50	20	150	--	530	500	--
	GT0.63-3.60-03-150-M1	3,6	40	10	630	31,5	80	20	150	--	530	500	--
	GT1.25-3.60-03-150-M1	3,6	40	10	1250	31,5	80	22	150	--	510	480	--
	GT1.60-3.60-03-150-M1	3,6	40	10	1600	31,5	80	25	150	--	510	480	--
	GT2.50-3.60-03-170-M1	3,6	40	10	2500	31,5	80	50	170	--	538	500	--
	GT3.15-3.60-03-180-M1	3,6	40	10	3150	31,5	80	52	180	--	670	640	--
	HAS3.15-3.60-03-200-KD1	3,6	40	10	3150	71	168	96	200	--	665	615	--
	HAS4.00-3.60-03-250-KD1	3,6	40	10	4000	71	168	105	250	--	800	750	--
	HAS6.30-3.60-03-300-TF1	3,6	40	10	6300	81	168	120	300	--	904	850	--
7,2kV 3-pole	GT0.63-7.20-03-210-L1	7,2	60	20	630	20	50	20,5	210	--	630	600	--
	GT0.63-7.20-03-210-M1	7,2	60	20	630	31,5	80	20,5	210	--	630	600	--
	GT1.25-7.20-03-210-M1	7,2	60	20	1250	31,5	80	36	210	--	630	600	--
	GT1.60-7.20-03-210-M1	7,2	60	20	1600	31,5	80	36	210	--	630	600	--
	GT2.50-7.20-03-210-M1	7,2	60	20	2500	31,5	80	36	210	--	618	580	--
	GT3.15-7.20-03-210-M1	7,2	60	20	3150	31,5	80	36	230	--	658	620	--
	HAS3.15-7.20-03-300-KD1	7,2	60	20	3150	71	168	105	300	--	950	910	--
	HAS4.00-7.20-03-400-KD1	7,2	60	20	4000	71	168	120	400	--	1330	1270	--
	HAS6.30-7.20-03-400-TF1	7,2	60	20	6300	81	168	150	400	--	1330	1270	--

TYP GT/HAS

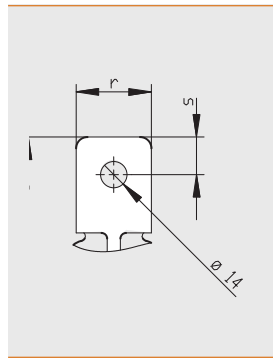
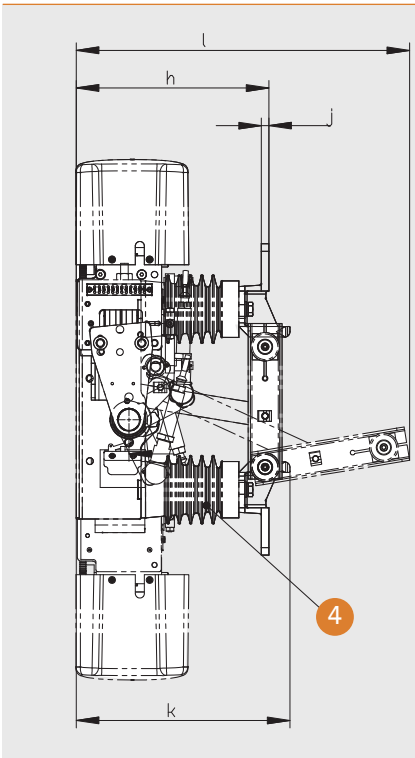

▶ 630 A

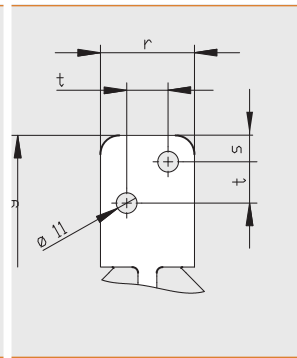

▶ 1250 A / 1600 A

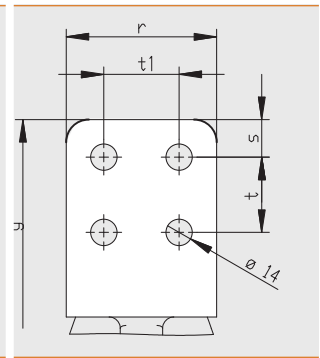

▶ 2500 A / 3150 A

- | | | |
|---|---|--|
| 1 Connection screws
630 A: M12
1250 A / 1600 A: M10
2500 A / 3150 A: M12 | 5 Motor drive | B Connection
Hand crank |
| 2 Earthing screw
1x M12 630A / 1250 A / 1600 A
2x M12 2500 A / 3150 A / 4000 A
6300 A | 5a Motor drive
Optional position | |
| 4 Stützer | 6 Auxiliary switches | Actuating
voltage indicated
upon order |
| | 6a Auxiliary switches
Optional position | |

e	f	g	h	j	k	l	m	n	r	s	t	t ₁	u	Typ	Number of poles
318	280	370	177	6	205	372	113	66	40	20	--	--	158	GT0.63-1.50-03-100-L1	1,5 kV 3-pole
318	280	414	207	10	235	391	113	90	50	14	22	22	180	GT1.25-1.50-03-100-M1	
262	224	357	182	10	210	299	105	90	50	14	22	22	172	GT1.60-1.50-03-100-M1	
408	340	570	224	22	255	444	113	80	80	20	40	40	228	GT2.50-1.50-03-130-M1	
330	262	492	224	22	255	360	120	80	80	20	40	40	235	GT3.15-1.50-03-150-M1	3,6 kV 3-pole
310	280	430	137	18	175	296	111	87	100	20	40	50	189	HAS3.15-1.50-03-180-K1	
318	280	370	177	6	205	371	113	90	40	20	--	--	158	GT0.63-3.60-03-150-L1	
318	280	370	177	6	205	371	113	90	40	20	--	--	158	GT0.63-3.60-03-150-M1	
318	280	414	191	10	219	375	113	90	50	14	22	--	180	GT0.63-3.60-03-150-M1	7,2kV 3-pole
318	280	414	191	10	219	375	113	90	50	14	22	--	180	GT0.63-3.60-03-150-M1	
408	340	570	224	22	255	449	113	80	80	20	40	--	228	GT2.50-3.60-03-170-M1	
492	300	262	210	22	241	360	113	80	80	20	40	--	228	GT3.15-3.60-03-180-M1	
365	325	446	208	18	--	395	--	107,5	100	20	40	50	194	HAS3.15-3.60-03-200-KD1	7,2kV 3-pole
325	240	498	215	20	--	430	--	125	120	20	40	60	217	HAS4.00-3.60-03-250-KD1	
325	260	538	235	20	--	465	--	125	160	20	40	40	236	HAS6.30-3.60-03-300-TF1	
318	280	370	242	6	270	445	113	90	40	20	--	--	158	GT0.63-7.20-03-210-L1	
318	280	370	242	6	270	445	113	90	40	20	--	--	158	GT0.63-7.20-03-210-M1	7,2kV 3-pole
318	280	414	256	10	284	445	113	90	50	14	22	--	180	GT1.25-7.20-03-210-M1	
318	280	414	256	10	284	445	113	90	50	14	22	--	180	GT1.60-7.20-03-210-M1	
408	340	570	289	22	320	525	113	80	80	20	40	--	228	GT2.50-7.20-03-210-M1	
408	340	570	289	22	395	525	113	80	80	20	40	--	228	GT3.15-7.20-03-210-M1	7,2kV 3-pole
350	265	500	308	18	350	560	85	155	100	20	50	50	200	HAS3.15-7.20-03-300-KD1	
424	344	549	347	20	400	614	120	235	120	20	40	60	225	HAS4.00-7.20-03-400-KD1	
424	344	588	367	20	425	654	122	235	160	20	40	40	245	HAS6.30-7.20-03-400-TF1	

▶▶▶ ISOLATOR/EARTH CONTACT COMBINATION
FOR ALTERNATING CURRENT APPLICATIONS ◀◀◀

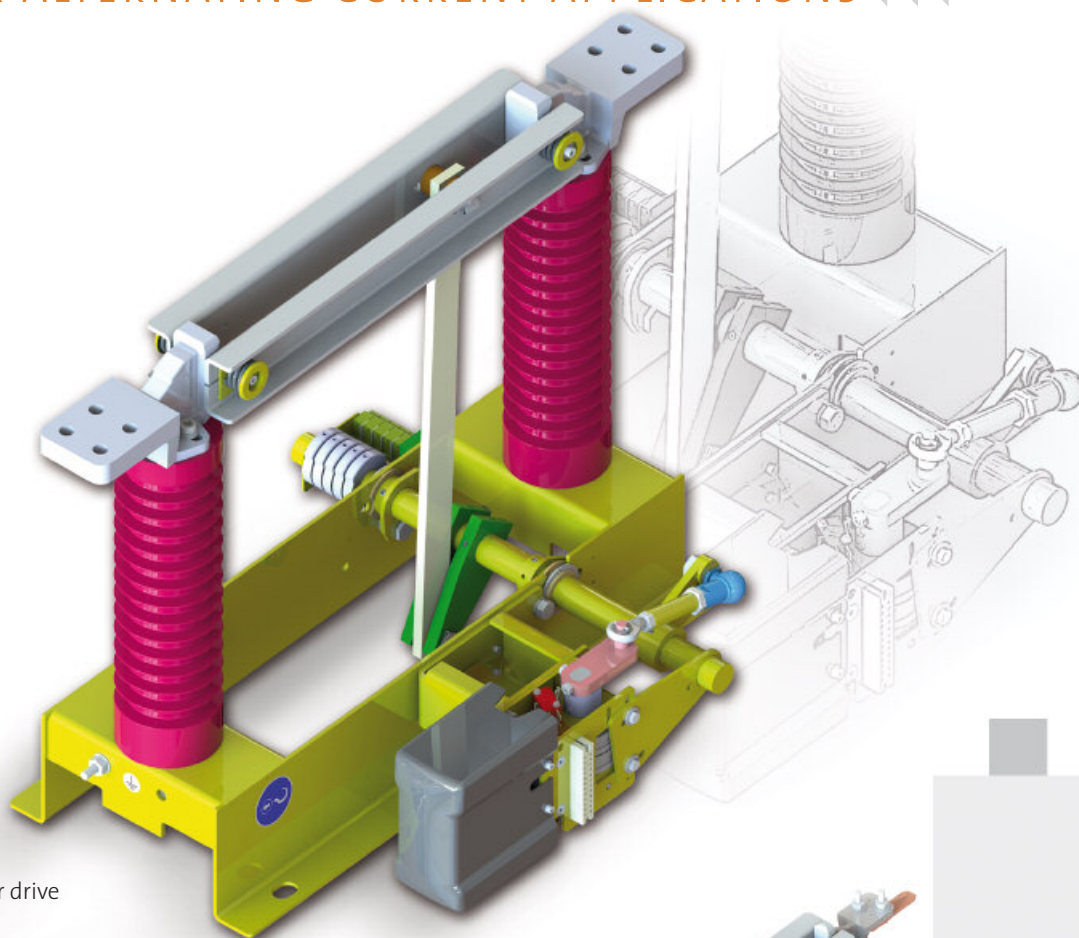

▶ GT isolator with motor drive

OUR GT/GTD/GTÖ/GTS DEVICES HAVE BEEN DEVELOPED FOR RAILWAY APPLICATIONS.

They cover a broad scope and allow diverse configurations. Anything is possible: from individual single-pole isolators to isolator/earth contact combinations with up to two earth contacts and two-pole design.

Various optional extras can also be selected.

In particular, a motor unit for the combined switching process of the isolator and a earth contact can also be used.

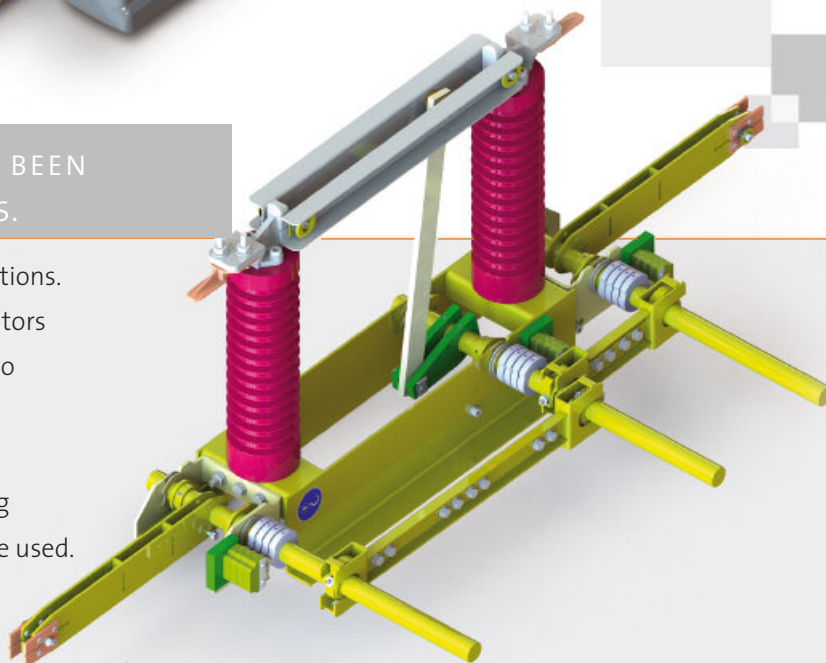

▶ GTS: Isolator with two earth contacts



FEATURES

- Indoor use
- Customer-specific design
- Large separation between the contacts
- Visible separation
- Also available as an outdoor version
- Multiple variations

PURSUANT TO
STANDARD:

IEC 62271-102

IEC 62505-2

EN 50123 TEIL 1,
TEIL 3, TEIL 4

The standard range includes devices with a voltage of 27,5 kV and currents of 1250 A to 2500 A. There are also special sizes of 630 A and 3150 A. For currents above 3150 A we refer to our HAS product range.”

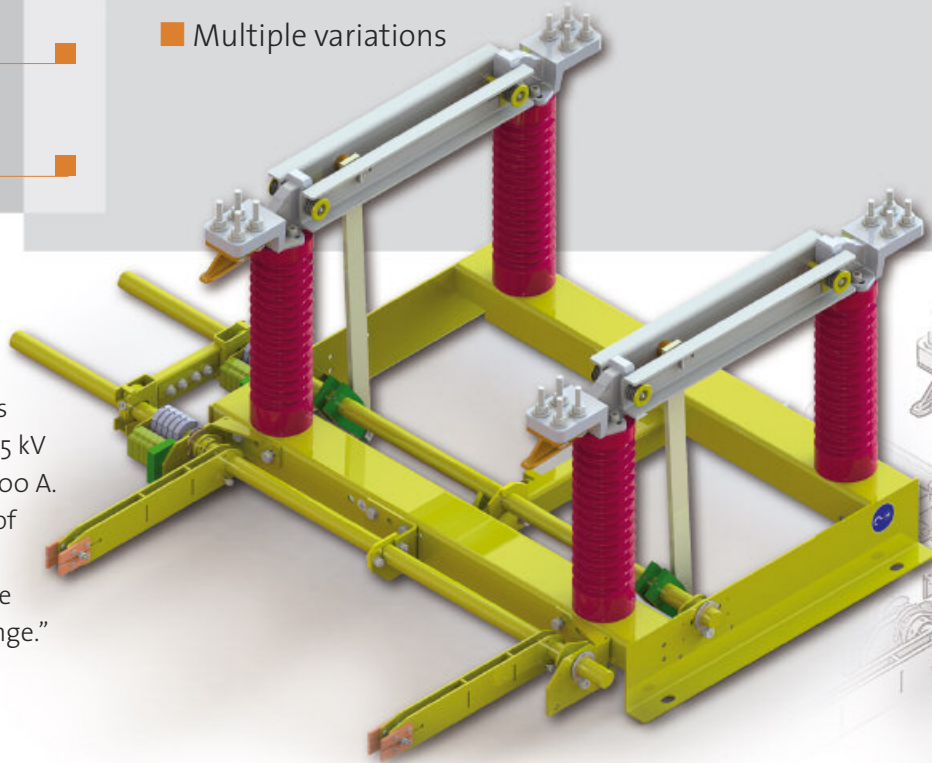

▶ Earth contact

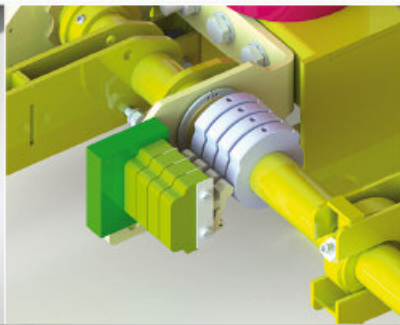

▶ Auxiliary switches

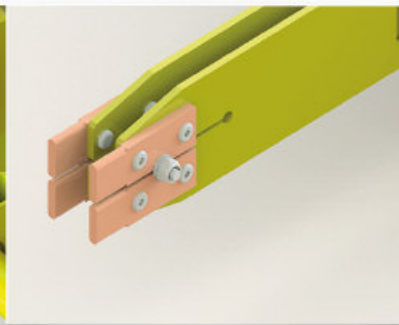

▶ Earth contact gauge

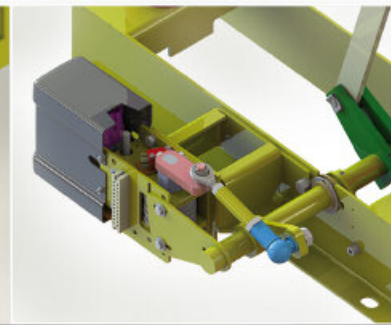

▶ Motor drive



You will find detailed information
in our THEMATIC BROCHURE

▶ **Medium-voltage switchgear**

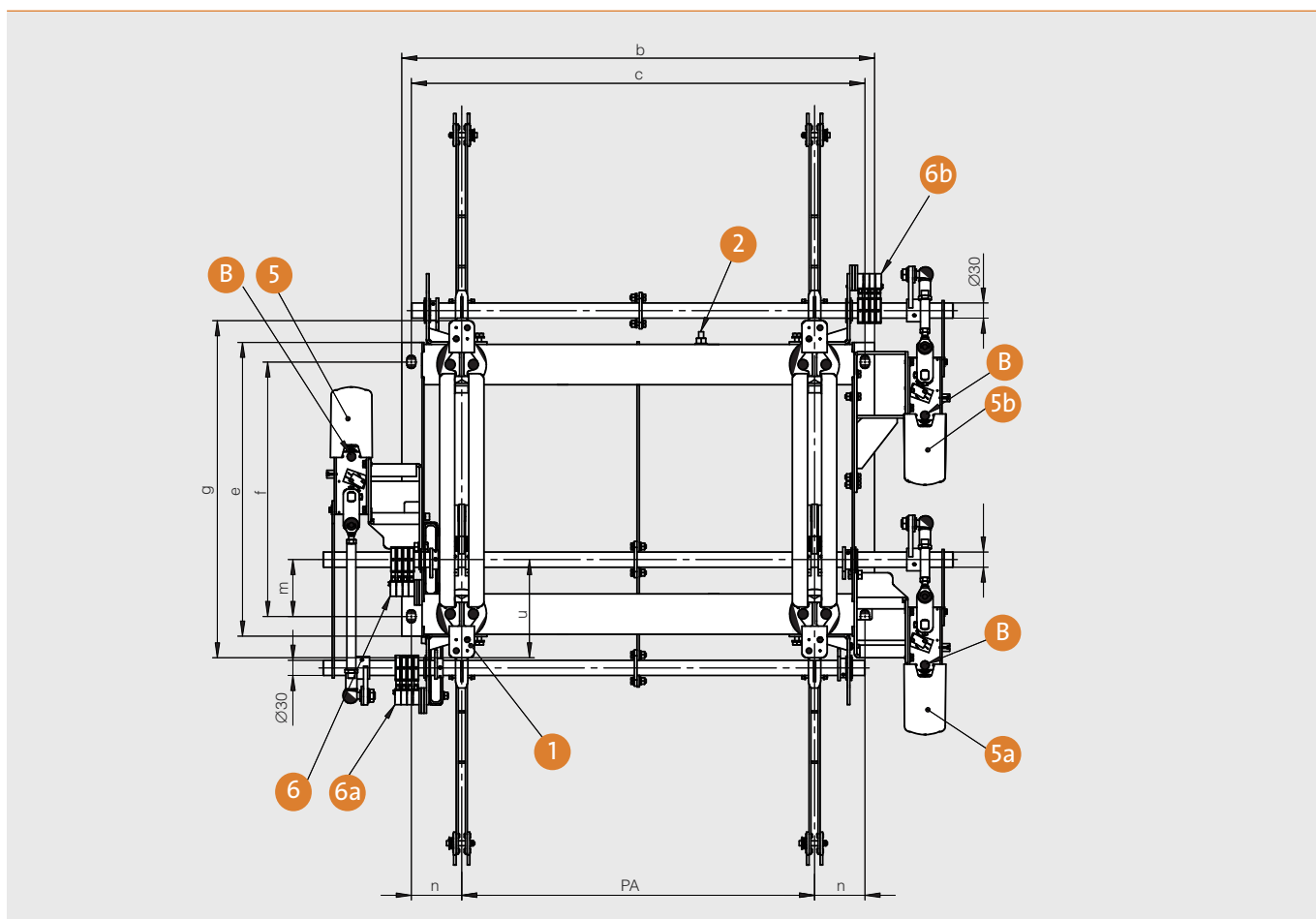

Number of poles	Typ GT	U_n [kV]	U_p [kV]	U_d [kV]	I_n [kA]	I_{th} [kA]	I_{dyn} [kA]	Gewicht [kg]	PA	b	c	e
27,5kV 1-pole	GT1.25-27.5-01-B1	27,5	200	95	1,25	25	62,5	32	--	238	200	583
	GT1.60-27.5-01-B1	27,5	200	95	1,60	25	62,5	32	--	238	200	583
	GT2.00-27.5-01-B1	27,5	200	95	2,00	25	62,5	42	--	288	250	635
	GT2.50-27.5-01-B1	27,5	200	95	2,50	25	62,5	42	--	288	250	635
	GTD.../GTÖ1.25-27.5-01-B1	27,5	200	95	1,25	25	62,5	46	--	238	200	583
	GTD.../GTÖ1.60-27.5-01-B1	27,5	200	95	1,60	25	62,5	46	--	238	200	583
	GTD.../GTÖ2.00-27.5-01-B1	27,5	200	95	2,00	25	62,5	57	--	288	250	635
	GTD.../GTÖ2.50-27.5-01-B1	27,5	200	95	2,50	25	62,5	57	--	288	250	635
	GTS1.25-27.5-01-B1	27,5	200	95	1,25	25	62,5	61	--	238	200	583
	GTS1.60-27.5-01-B1	27,5	200	95	1,60	25	62,5	61	--	238	200	583
	GTS2.00-27.5-01-B1	27,5	200	95	2,00	25	62,5	72	--	288	250	635
	GTS2.50-27.5-01-B1	27,5	200	95	2,50	25	62,5	72	--	288	250	635
	27,5kV 2-pole	GT1.25-27.5-02-700-B1	27,5	200	95	1,25	25	62,5	55	700	938	900
GT1.60-27.5-02-700-B1		27,5	200	95	1,60	25	62,5	55	700	938	900	583
GT2.00-27.5-02-700-B1		27,5	200	95	2,00	25	62,5	77	700	988	950	635
GT2.50-27.5-02-700-B1		27,5	200	95	2,50	25	62,5	77	700	988	950	635
GTD.../GTÖ1.25-27.5-02-700-B1		27,5	200	95	1,25	25	62,5	78	700	938	900	583
GTD.../GTÖ1.60-27.5-02-700-B1		27,5	200	95	1,60	25	62,5	78	700	938	900	583
GTD.../GTÖ2.00-27.5-02-700-B1		27,5	200	95	2,00	25	62,5	101	700	988	950	635
GTD.../GTÖ2.50-27.5-02-700-B1		27,5	200	95	2,50	25	62,5	101	700	988	950	635
GTS1.25-27.5-02-700-B1		27,5	200	95	1,25	25	62,5	100	700	938	900	583
GTS1.60-27.5-02-700-B1		27,5	200	95	1,60	25	62,5	100	700	938	900	583
GTS2.00-27.5-02-700-B1		27,5	200	95	2,00	25	62,5	124	700	988	950	635
GTS2.50-27.5-02-700-B1		27,5	200	95	2,50	25	62,5	124	700	988	950	635

TYP GT/GTD/GTÖ/GTS

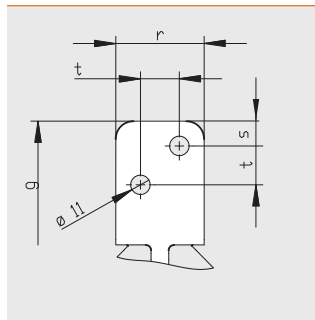
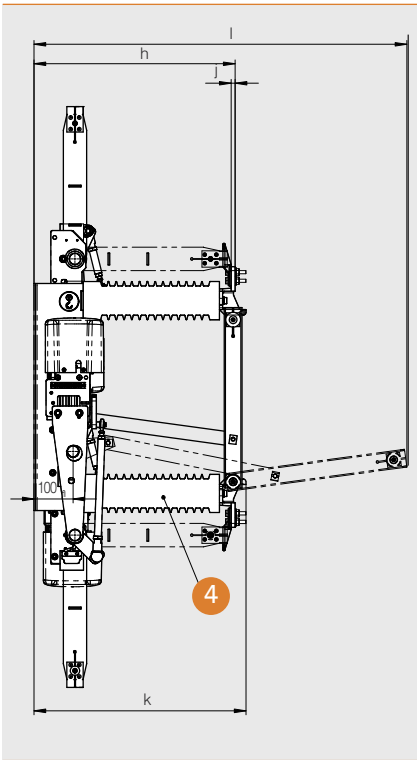

▶ 1250 A / 1600 A

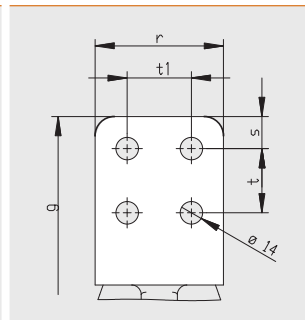

▶ 2500 A / 3150 A

Actuating voltage indicated upon order

- 1 Connection screws
1250 A / 1600 A: M10
2000 A / 2500 A: M12
- 2 Earthing screw
einpolig: M10
zweipolig: M12
- 4 Supports
- 5 Position of motor drive-bottom left for isolator switches (without earthing switch) or for earthing switches-rotation-point side
- 5a Position of motor drive – bottom right isolator switches (with earthing switch/n)
- 5b Position of motor drive – top right for earthing switches, opening side
- 6 Auxiliary switches, isolator
- 6a Auxiliary switches, earth contacts, rotation-point side
- 6b Auxiliary switches, earth contacts, opening side
- B Hand crank connection

View without expansion strips

f	g	h	j	k	l	m	n	r	s	t	u	Typ GT	Number of poles	
505	669	516	10	544	957	113	100	50	14	22	195	GT1.25-27.5-01-B1	27,5 kV 1-pole	
505	669	516	10	544	957	113	100	50	14	22	195	GT1.60-27.5-01-B1		
497	797	535	22	566	988	103	125	80	20	40	253	GT2.00-27.5-01-B1		
497	797	535	22	566	988	103	125	80	20	40	253	GT2.50-27.5-01-B1		
505	669	516	10	544	957	113	100	50	14	22	195	GTD.../GTÖ1.25-27.5-01-B1		
505	669	516	10	544	957	113	100	50	14	22	195	GTD.../GTÖ1.60-27.5-01-B1		
497	797	535	22	566	988	103	125	80	20	40	253	GTD.../GTÖ2.00-27.5-01-B1		
497	797	535	22	566	988	103	125	80	20	40	253	GTD.../GTÖ2.50-27.5-01-B1		
505	669	516	10	544	957	113	100	50	14	22	195	GTS1.25-27.5-01-B1		
505	669	516	10	544	957	113	100	50	14	22	195	GTS1.60-27.5-01-B1		
497	797	535	22	566	988	103	125	80	20	40	253	GTS2.00-27.5-01-B1		
497	797	535	22	566	988	103	125	80	20	40	253	GTS2.50-27.5-01-B1		
505	669	516	10	544	957	113	100	50	14	22	195	GT1.25-27.5-02-700-B1		27,5kV 2-pole
505	669	516	10	544	957	113	100	50	14	22	195	GT1.60-27.5-02-700-B1		
497	797	535	22	566	988	103	125	80	20	40	253	GT2.00-27.5-02-700-B1		
497	797	535	22	566	988	103	125	80	20	40	253	GT2.50-27.5-02-700-B1		
505	669	516	10	544	957	113	100	50	14	22	195	GTD.../GTÖ1.25-27.5-02-700-B1		
505	669	516	10	544	957	113	100	50	14	22	195	GTD.../GTÖ1.60-27.5-02-700-B1		
497	797	535	22	566	988	103	125	80	20	40	253	GTD.../GTÖ2.00-27.5-02-700-B1		
497	797	535	22	566	988	103	125	80	20	40	253	GTD.../GTÖ2.50-27.5-02-700-B1		
505	669	516	10	544	957	113	100	50	14	22	195	GTS1.25-27.5-02-700-B1		
505	669	516	10	544	957	113	100	50	14	22	195	GTS1.60-27.5-02-700-B1		
497	797	535	22	566	988	103	125	80	20	40	253	GTS2.00-27.5-02-700-B1		
497	797	535	22	566	988	103	125	80	20	40	253	GTS2.50-27.5-02-700-B1		